

RVE Series

CCW-RVE-220W-1D-50/70-SS/WP
CCW-RVE-220W-2D-50/70-SS/WP
CCW-RVE-220W-2S-50/70-SS/WP

Robust, versatile and accurate weighing for bulky products

Designed to handle heavy or bulk-free-flowing and sticky products, this weigher can be adapted to suit many packaging scenarios. Configured in a stainless steel finish or with an enhanced water proof design, the RVE series is built for long life operations in dry, fresh or frozen applications.

- ▲ For heavy or bulky product applications
- ▲ Mid to high speeds and excellent weighing yields
- ▲ Pre-configured for smart factories
- ▲ Achieves maximum speeds of up to 120wpm



Dimensions

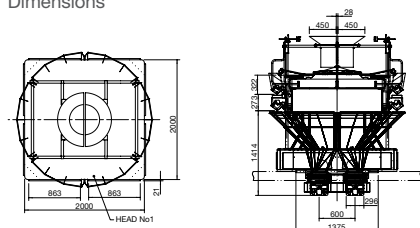

CCW-RVE-220W-2D-50(70)-SS/WP

Performance	CCW-RVE-220W-1D-50-SS/WP CCW-RVE-220W-2D-50-SS/WP		CCW-RVE-220W-2S-50-SS/WP		CCW-RVE-220W-1D-70-SS/WP CCW-RVE-220W-2D-70-SS/WP		CCW-RVE-220W-2S-70-SS/WP	
	Max. weighing speed*	120 WPM		60 WPM		120 WPM		60 WPM
Max. vol. for weighing (per single dump)	10 litres				14 litres			
Max piece length	170mm				270mm			
Weighing capacity setting (per head)	2000g	4000g	2000g	4000g	2000g	4000g	2000g	4000g
Minimum graduation	0.5g	1.0g	0.5g	1.0g	0.5g	1.0g	0.5g	1.0g
Machine target weight range	105-4000g	375-8000g	105-4000g	375-8000g	105-4000g	375-8000g	105-4000g	375-8000g
Specification								
Touch screen display (RCU)	10.4" Colour LCD Display							
Number of presets	200							
Weigh cell	Ishida double-beam strain gauge loadcell							
Materials	Surfaces are made of 304 stainless steel or other sanitary materials							
IP test rating	SS: IP54 Rating / WP: IP65 Rating (with optional factory fitted moisture sensors and alarm)							
Power	Wattage	1.3kW						
	Voltage	200-240V 50/60Hz 1-phase						
Air**	110 litres/min (ANR) 0.5 Mpa Air hose - PT 3/8" (for air dryer connection) Air purge 0.02-0.03 Mpa							
Net weight***	Approx. 1800kg							
Standard Compliance	CE/RoHS							

Design and specifications are subject to change without notice (please confirm dimensions at point of order).

* Depends on product shape, product density, target weight, feeding conditions, etc.

** Compressed air supply is required only for WP machines. Note: Air hose compressor must be provided by user.

*** The machine weight varies depending on the options selected.

RVE Series

Ishida has over 120 years history of weighing innovation, with more multihead weighers installed and adding value than any other supplier. The upgraded RVE series represents the latest in multihead weighing performance for speed, accuracy and reliability, and comes with a wide range of features to ensure high performance industrial weighing is achieved at an interesting price point.

Features & Benefits

Fast and precise weighing for improved productivity

High performance features include:

- ▲ Pulse width modulation offers auto tuning of dispersion table and radial troughs
- ▲ Programmable 5 stage digital filtering
- ▲ Advanced automatic feeder adjustments
- ▲ High processing speed 10.4" web RCU

Increased yield and productivity

- ▲ Reduced giveaway and waste compared to conventional filling/weighing or semi-automated machines
- ▲ High processing capacity significantly improves production output
- ▲ Economical investment with a short payback period
- ▲ Contact part options to fit a wide range of solutions

User-friendly design and easy set-up

Intuitive, easy-to-use RCU (Remote Control Unit)

- ▲ Simplifies initial set up and daily operations
- ▲ Minimises machinery downtime
- ▲ Maximises production efficiency
- ▲ Auto frequency tuning on vibration parts to ensure maximum power and control is always maintained
- ▲ Important for sticky or bulky products
- ▲ USB data import/export with ethernet connectivity

Minimised machine downtime

- ▲ Tool-free, interchangeable contact parts reduces cleaning time
- ▲ Simple operation RCU screens are easy to learn and prevent operator errors
- ▲ Optional factory fitted moisture sensors to alarm in the presence of any moisture in three zones within weigher

Pre-configured for SMART FACTORIES

- ▲ Increased productivity with Industry 4.0
- ▲ Sentinel™ Reporting Pack included free of charge for life
- ▲ Provides instant visibility of live machine performance from anywhere in the world
- ▲ Optional access to remote technical support, rapid response diagnosis and pro-active performance monitoring

Compliance with FDA and EU Food Contact standards

All materials are FDA-approved and comply with Article 16(1) of Regulation (EC) No 1935/2004 and Article 15 of Regulation 10/2011. To fully meet the EU's Restriction of Hazardous Substances Directive (RoHS) non-hazardous materials are used for all circuit boards, parts, materials, and finishes.

ISHIDA EUROPE LIMITED
Kettles Wood Drive
Woodgate Business Park
Birmingham
B32 3DB
United Kingdom
Tel: +44 (0)121 607 7700
Fax: +44 (0)121 607 7888
info@ishidaeurope.com

ISHIDA CZECH REPUBLIC
Tel: +420 220 960 422
info@ishidaeurope.cz

ISHIDA ROMANIA
Tel: +4 021 326 69 81
Fax: +4 021 326 69 82
info@ishidaeurope.ro

ISHIDA EAST AFRICA
Tel: +254 (0)202 000425
info@ishidaeurope.com

ISHIDA RUSSIA AND CIS
Tel: +7 499 272 05 36
Fax: +7 499 272 05 37
info@ishidaeurope.ru

ISHIDA FRANCE
Tel: +33 (0)1 48 63 83 83
Fax: +33 (0)1 48 63 24 29
info@ishidaeurope.fr

ISHIDA SOUTH AFRICA
Tel: +27 (0)11 976 2010
Fax: +27 (0)11 976 2012
info@ishidaeurope.com

ISHIDA GERMANY
Tel: +49 (0)791 945 160
Fax: +49 (0)791 945 1699
info@ishida.de

ISHIDA SWEDEN
Tel: +46 (0)31 871 320
info@ishidaeurope.se

ISHIDA MIDDLE EAST
Tel: +971 (0)4 299 1933
Fax: +971 (0)4 299 1955
ishida@ishida.ae

ISHIDA SWITZERLAND
Tel: +41 (0)41 799 7999
Fax: +41 (0)41 790 3927
info@ishida.ch

ISHIDA NETHERLANDS
Tel: +31 (0)499 39 3675
Fax: +31 (0)499 39 1887
info@ishida.nl